

# NACHI

Panel Mount Proportional Valve, Digital Control Amplifier

# ERD

## PA5D6-EI-D2-20

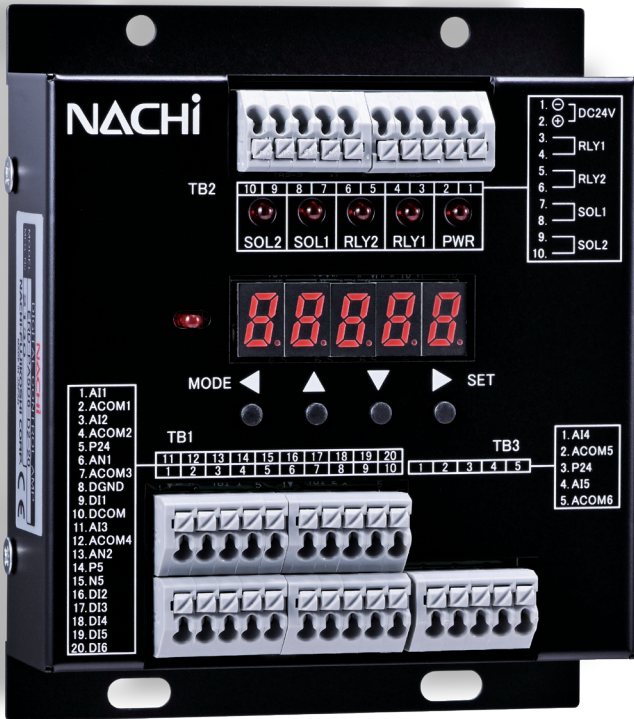

### Reduces time required for set up and adjustment

- Digital Parameters provide easy fine tuning.
- Simplifies parameter setting for repeat orders.
- Push in terminals provide easy installation without tools

### Compatible with Industrial Network

- Monitor status, input signal, and more with EtherNet/IP communication
- Digital communication provides better response time and accuracy than analog is less susceptible to noise.

#### New Function

Compatible with industrial network EtherNet/IP  
Possible to set parameters, command valve, monitor output valve

#### New Function

Drive two valves simultaneously  
Valves control pressure feedback

#### Industrial Network Communication Reduces wiring



#### USB communication Set parameters with our dedicated PC software tool

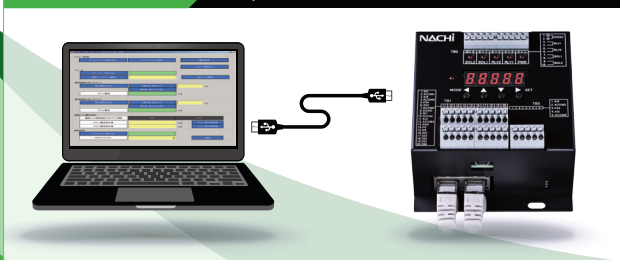

#### Wiring Easy wiring connection with push in terminals

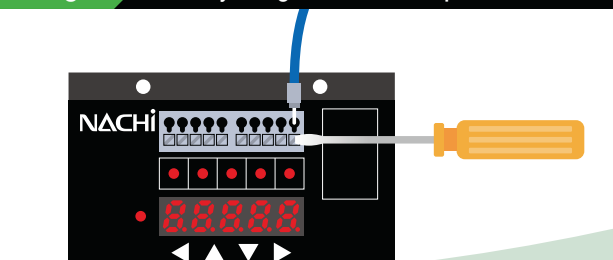

## Characteristics

- Each parameter can be set using the numeric display**  
 All parameters can be set by numbers. For example, dither frequency or output current max value can be simply entered with numbers.
- Bit Pattern Input** New Function  
 When 1 proportional solenoid is running, command current can be switched up to 32 patterns.
- Multi function such as output current monitoring**  
 Includes output current to solenoid coil monitoring function or an alarm such as coil short can be displayed.
- Simple Setup**  
 Using our dedicated software tool, you can now backup or set all parameters at once. This enables easy programming of a second control amplifier or more.
- Pressure feedback control function** New Function  
 Controls pressure feedback of 2 valves at the same time. Suppresses pressure difference from operation oil temperature change or override characteristic. Input signal can switch feedback control On/Off.
- CE marking**  
 Following safety regulation CE marking.

## Specification

Item	Specifications	
Supply Voltage / Current Consumption	DC24V (22~30V) / max 2.2A	
Operation temperature / humidity	0~55°C/Less than 90%RH	
Input Options	Analog Input	Analog signal to drive 2 proportional solenoids
	Contact input	Send an analog signal to drive preset output contact or ramp/time sequence output
	Bit pattern input	1 proportional solenoid:32 pattern, 2 proportional solenoids:
	EtherNet/IP	Cyclic digital communication will make commands
Input Signal	Analog input port	0-10V input : 4ch, ±10V : 1ch
	Digital input	6ch contact input
Output Signal	Solenoid output	0~900mA:2ch
	Signal output	Output current wave or pressure sensor voltage: 2ch
Display and Operation Method	LED display, 5 digit display, 4 operational buttons	
USB terminal	miniUSB typeB	
Compatible proportional valve	Pressure control valve, flow control valve, directional flow control valve	
EtherNet/IP spec	Adapter operation conformance test CT-18	
Safety Regulation	CE marking (self declaration)	

## Dimensions

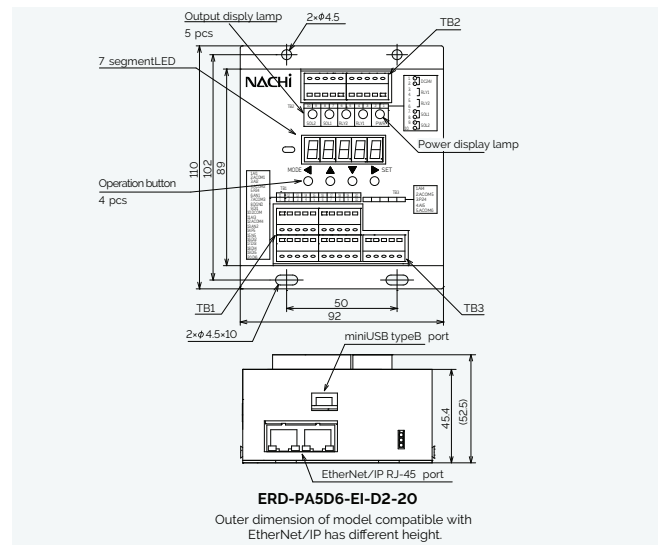

## Model Code

### ERD-PA5 D6 -EI-D2-20

