

- NEMA 4 electrical rating
- CE marked
- Dual timers allow full adjustment of both the drain interval (0.5 to 45 minutes) and the valve actuation duration (0.5 to 10 seconds)
- Two indicator lights for visual inspection of power on and valve actuation
- Solid state electronics
- Durable brass body
- Manual test switch
- Non-position sensitive installation



### Technical data

|                          |                          |
|--------------------------|--------------------------|
|                          | <b>Timer</b>             |
| Interval Time T2(1)      | 0.5 - 45 minutes         |
| Discharge Time T1(1)     | 0.5 - 10 seconds         |
| Manual Test Switch       |                          |
| Supply Voltage (2)       | 24V - 240V± 10% 50/60Hz  |
| Current Consumption      | Max. 4mA                 |
| Operating Temperature    | 32° to 130°F             |
| Environmental Protection | IP 65 NEMA 4             |
| Case Material            | ABS Plastic FR Grade     |
| Connection               | DIN 43650A ISO 4400/6952 |
| Indicators (2)           | Yellow, valve open       |
| Yellow, valve closed     |                          |

|                          |                                |
|--------------------------|--------------------------------|
|                          | <b>Valve</b>                   |
| Type                     | 2/2-Way direct acting valve    |
| In/Out Ports             | 1/4", 3/8", 1/2" NPT-Female    |
| Max. Working Pressure    | 300 Psi                        |
| Operating Temperature    | 32°F/130°F ambient             |
| Media Temperature        | Max. 194°F                     |
| Valve Body               | Stainless Steel, Orifice 3/16" |
| Insulation               | Thermal group H                |
| Environmental Protection | IP 65 NEMA 4                   |
| Supply Voltage*          | 24V - 240V                     |
| Voltage Tolerance        | ± 10%                          |
| Mounting                 | Any position                   |

\*See coil for the correct supply voltage

**Function:**The function of the electronic drain valve is to drain condensate from air compressors, air dryers, condensate separators and air filters. The condensate can be drained in any interval between the adjustable time cycles of 0.5 to 45 minutes. The draining time can be set between 0.5 to 10 seconds.

**CAUTION**  
When using DC (Direct current), the positive pole (+) should be connected to connector 1.

|                      |        |
|----------------------|--------|
| <b>Service Parts</b> |        |
| Timer                | 8030   |
| Service Kit          | 298211 |
| Coils                |        |
| 230 VAC              | 297100 |
| 115 VAC              | 297600 |
| 24 VAC               | 297300 |
| 24 VDC               | 297400 |

| Part Number | Port Size | Voltage |
|-------------|-----------|---------|
| 17-020-300  | 1/4" NPT  | 115 VAC |
| 17-020-303  | 3/8" NPT  | 115 VAC |
| 17-020-306  | 1/2" NPT  | 115 VAC |
| 17-020-301  | 1/4" NPT  | 230 VAC |
| 17-020-304  | 3/8" NPT  | 230 VAC |
| 17-020-307  | 1/2" NPT  | 230 VAC |
| 17-020-302  | 1/4" NPT  | 24 VDC  |
| 17-020-305  | 3/8" NPT  | 24 VDC  |
| 17-020-308  | 1/2" NPT  | 24 VDC  |



| Item | Qty | Description    |
|------|-----|----------------|
| 3A   | 1   | Gasket         |
| 3    | 1   | Connector      |
| 2C   | 1   | Washer         |
| 2B   | 1   | Nut            |
| 2A   | 1   | Coil           |
| 2    | 1   | Solenoid Valve |
| 1B   | 1   | Gasket         |
| 1A   | 1   | Screw          |
| 1    | 1   | TEC-22N Timer  |

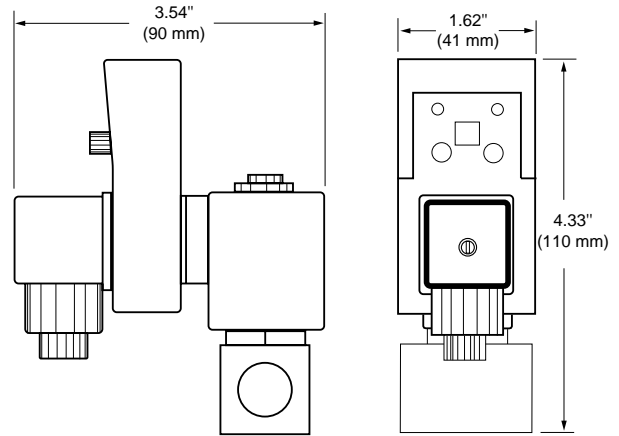
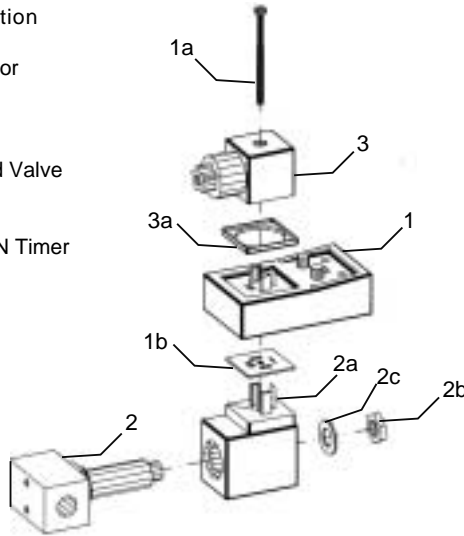

**CAUTION!** When installing the electronic drain valve make sure that:

- Compressed air is vented. (zero pressure)
- Electric power is switched off

Installation of the electronic drain valve  
Valve

When installing the electronic drain valve take note of the direction of the arrow on the valve. The arrow should comply with the flow direction of the condensate. The electronic drain valve can be mounted in any position. An appropriate reservoir should be installed mounted on the outlet side of the valve to collect the condensate. This can also be done using a pipe line. Beware when using a hose that no whiplash can occur when the valve is open.

Timer

Undo the screw on the top of the connector. Remove the plug from the timer. Remove the protection cap from the connector. Connect the cable.

Warning

These products are intended for use in industrial compressed air systems only. Do not use these products where pressures and temperatures can exceed those listed under Specifications.

Before using these products with fluids other than those specified, for non-industrial applications, life-support systems, or other applications not within published specifications, consult NORGREN.

Through misuse, age, or malfunction, components used in fluid power systems can fail in various modes. The system designer is warned to consider the failure modes of all component parts used in fluid power systems and to provide adequate safeguards to prevent personal injury or damage to equipment in the event of such failure modes. System designers must provide a warning to end users in the system instructional manual if protection against a failure mode cannot be adequately provided.

System designers and end users are cautioned to review specific warnings found in instruction sheets packed and shipped with these products. System designers should also provide for all OSHA requirements including Title 29 CFR 1910.147 Lockout/Tagout.

It should be recognized that warnings are valid for any product, regardless of manufacturer, and are not restricted to products manufactured by Norgren. Norgren's reputation for product quality and performance is well established. We feel we have the additional obligation to provide information or warnings to customers to assist them in applying our products in a reasonable and safe manner.

Warranty

Limited Warranty, Disclaimer & Limitation of Remedies

Norgren products are warranted unconditionally for a period of two years from the date of purchase from Norgren, provided said items are used according to Norgren's recommended usages and within Norgren's specifications. Norgren's liability is limited to the repair of, or replacement in kind of, at Norgren's sole option, any items proved defective, provided these items are returned to Norgren prepaid. To confirm date of purchase, invoice date or invoice number must be furnished; otherwise, date code on product will be used to determine eligibility for warranty coverage. The warranties expressed above are in lieu of and exclusive of all other warranties.

There are no other warranties, expressed or implied, except as stated herein. There are no implied warranties of merchantability or fitness for a particular purpose, which are specifically disclaimed. Norgren's liability for breach of warranty as herein stated is the exclusive remedy, and in no event shall Norgren be liable or responsible for incidental or consequential damages, even if the possibility of such incidental or consequential damages has been made known to Norgren.

Norgren reserves the right to discontinue manufacture of any product or change product materials, design, or specifications without notice.