

Excelon® design allows in-line or modular installation

Valves can be locked in the closed position only

Excelon® 3-port/2-position lockout valves help conform to OSHA Lockout regulations in USA market.



Technical data

Fluid:

Compressed air, neutral gases
 NOTE: Contact technical support for use with other media.

Maximum Pressure:

250 psig (17 bar)

Operating Temperature*:

-30° to 150°F (-34° to 65°C)
 * Air supply must be dry enough to avoid ice formation at temperatures below 35°F (2°C).

Cv factor from IN to OUT ports

72 1/4" ports: 4.0

73 3/8" ports: 8.0

74 1/2" ports: 8.1

74 3/4" ports: 7.7

Cv factor from OUT to Exhaust ports on 3-port/2-position valves: 0.2.

Exhaust port threads on T72T and T73T models: 10-32

Exhaust port threads on T74T models:

1/8 PTF with PTF main ports

1/8" ISO Rc with ISO G main ports

Hole diameter in slide for padlock: 72 and 73: 5/16" (8 mm)

Hole diameter in slide for padlock: 0.29" (7.5 mm)

Materials

Body: zinc

Slide: acetal plastic

Elastomers: nitrile

Ordering information

Models listed are with PTF threads.

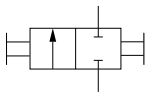
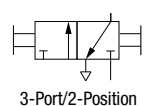
ISO Symbols	Port Size	2-Port/2-Position No exhaust outlet	3-Port/2-Position (OSHA) Unthreaded exhaust port	3-Port/2-Position Threaded exhaust port	Weight lbs (kg)
 2-Port/2-Position	1/4"	T72B-2AA-P1N	T72E-2AA-P1N	T72T-2AA-P1N	0.79 (0.36)
	3/8"	T72B-3AA-P1N	T72E-3AA-P1N	T72T-3AA-P1N	0.86 (0.39)
	Port Size	2-Port/2-Position No exhaust outlet	3-Port/2-Position (OSHA) Unthreaded exhaust outlet	3-Port/2-Position Threaded exhaust port	Weight lbs (kg)
	1/4"	T73B-2AA-P1N	T73E-2AA-P1N	T73T-2AA-P1N	0.7 (0.3)
	3/8"	T73B-3AA-P1N	T73E-3AA-P1N	T73T-3AA-P1N	0.7 (0.3)
	1/2"	T73B-4AA-P1N	T73E-4AA-P1N	T73T-4AA-P1N	0.7 (0.3)
 3-Port/2-Position	Port Size	2-Port/2-Position Padlock closed only No exhaust outlet	3-Port/2-Position (OSHA) Padlock closed only Unthreaded exhaust port	3-Port/2-Position Padlock closed only Threaded exhaust port	Weight lbs (kg)
	3/8"	T74B-3AA-P1N	T74E-3AA-P1N	T74T-3AA-P1N	0.69 (0.32)
	1/2"	T74B-4AA-P1N	T74E-4AA-P1N	T74T-4AA-P1N	0.65 (0.30)
	3/4"	T74B-6AA-P1N	T74E-6AA-P1N	T74T-6AA-P1N	0.62 (0.28)

Service kits*

Type	Part Number
T72	4384-513
T73B (black slide)	4384-610
T73E (yellow slide)	4384-611
T73T (red slide)	4384-612
T74B (black slide)	4384-711
T74E (yellow slide)	4384-710
T74T (red slide)	4384-713

* Service kit includes seals and slide.

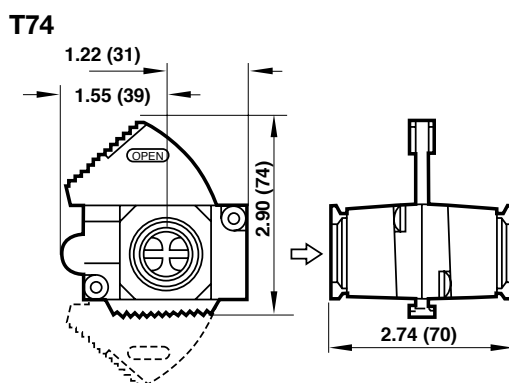
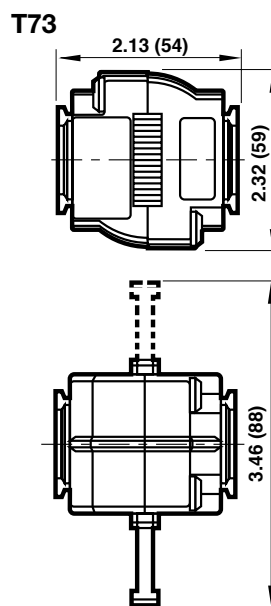
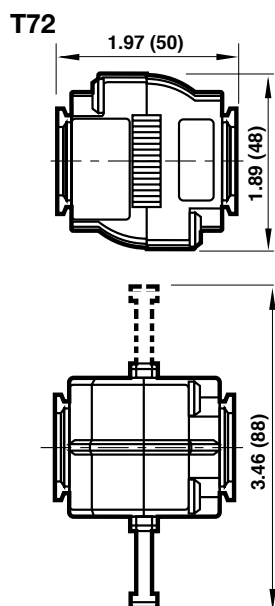

Dimensions in inches (mm)